

> Pipe-to-pipe and threaded connectors

Ø
1/2"
3/4"

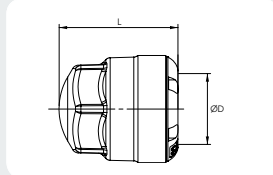

End cap

Transair	ØD (in)	L
RR25 H3 01	1/2	41.1
RR25 H5 01	3/4	54.5

Ø
1 1/2"
2"

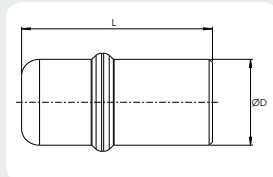

Transair	ØD (in)	L
RR25 M4 00	1 1/2	85
RR25 M6 00	2	80

Ø
3"
4"

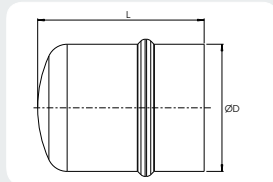

Transair	ØD	L
RX25 L1 00	3	99.6
RX25 L3 00	4	107.4

Use connector RR01 to connect end-cap RX25 to Transair pipe.

Ø
1/2"
3/4"

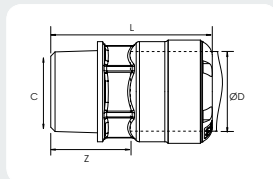

Male stud fitting, NPT

Transair	ØD (in)	C	L	Z
RR05 H3N04 01	1/2	1/2	51.1	20.7
RR05 H3N06 01	1/2	3/4	52.6	22.2
RR05 H5N04 01	3/4	1/2	63.6	22.1
RR05 H5N06 01	3/4	3/4	65.5	22.1

Ø
1 1/2"
2"

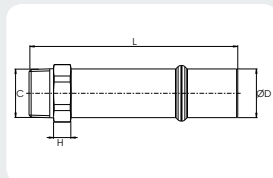

Male adaptor, NPT

Transair	ØD	C	L	H
RR05 M4N10	1 1/2	1 1/4	183	15
RR05 M4N12	1 1/2	1 1/2	183	15
RR05 M6N16	2	2	192	15
RR05 M6N20	2	2 1/2	195	15

Ø
3"

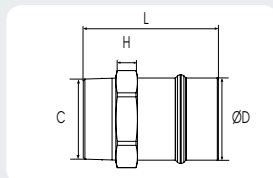

Transair	ØD	C (in)	L	H
RR21 L1N20	3	2 1/2	125	20
RR21 L1N24	3	3	125	20